



Your authorised dealer will be glad to assist you:

CX6934

U&Z

U&Z

U&Z

Integration into IDS

Some Clex locking units (cylinders, door fittings, wall mounted readers) can now also enable and disable intrusion detection systems (IDS), apart from just locking and unlocking doors, using an authorised transponder. An additional enabling unit at the door is therefore no longer required.

The locking unit communicates with the intrusion detection system via the IDS module using bidirectional signals. When enabled, it is not possible to unlock the door, even with an authorised transponder. When a transponder authorised for the IDS is held in front of the locking unit, it sends a switching command to the IDS via the IDS module. Using visual and audible signals at the locking unit, the user is notified about the current status (IDS enabled, IDS disabled, IDS not ready for enabling, the door cannot be opened, etc.).

The functionality is compatible with the following U&Z products:

- Clex prime CX6120/CX6120 IP66 + Clex private CX2120/CX2120 IP66
- Clex prime CX6162 + Clex private CX2162
- Clex prime CX6182 + Clex private CX2182
- Clex prime CX6172/CX6174 + Clex private CX2172/CX2174
- Clex prime CX6130/CX6132/CX6134 + Clex private CX2130/CX2132/CX2134 (wired)

For all available transponder types (EM/HITAG, MIFARE® and LEGIC®).

Functionality

Transponders with IDS access rights can enable or disable the IDS by holding the transponder in front of the locking unit for two reading cycles. The status of the IDS is signaled on the locking unit immediately after enabling or disabling the system.

Examples from our product range:



CX6934

IDS module as interface between the U&Z door electronics and an intrusion detection system (IDS)



CX6122/CX2122

Double-knob cylinder with electronic authorisation on one side, as CX6124/CX2124 also available with electronic authorisation on both sides



CX6162/CX2162

Compact electronic double-knob cylinder with electronic authorisation on one side



CX6172/CX2172

Electronic door handle with electronic authorisation on one side, as CX6174/CX2174 also available as electronic door fitting



CX6132/CX2132

Wall mounted reader for switching potential-free contacts

201902-EN



Integration into Intrusion Detection Systems

THE IDS MODULE



Clex
prime

Clex
private

UZ

Connect up to 16 electronic locking units
to one IDS module



IDS Module
CX6934



Intrusion Detection System

Connection of IDS

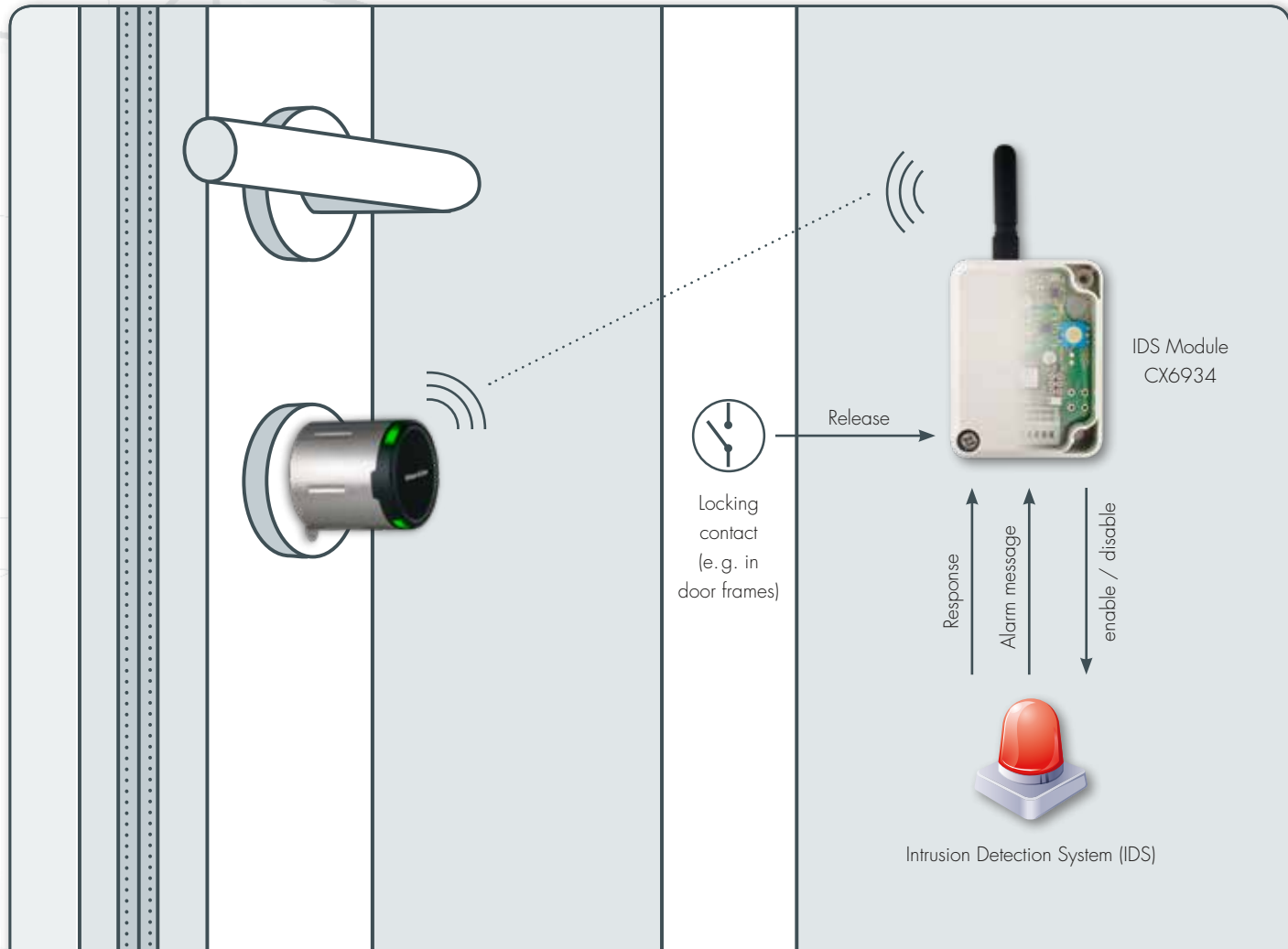

Connection Diagram